

HOW TO REMOVE YOUR CURRENT WHEEL

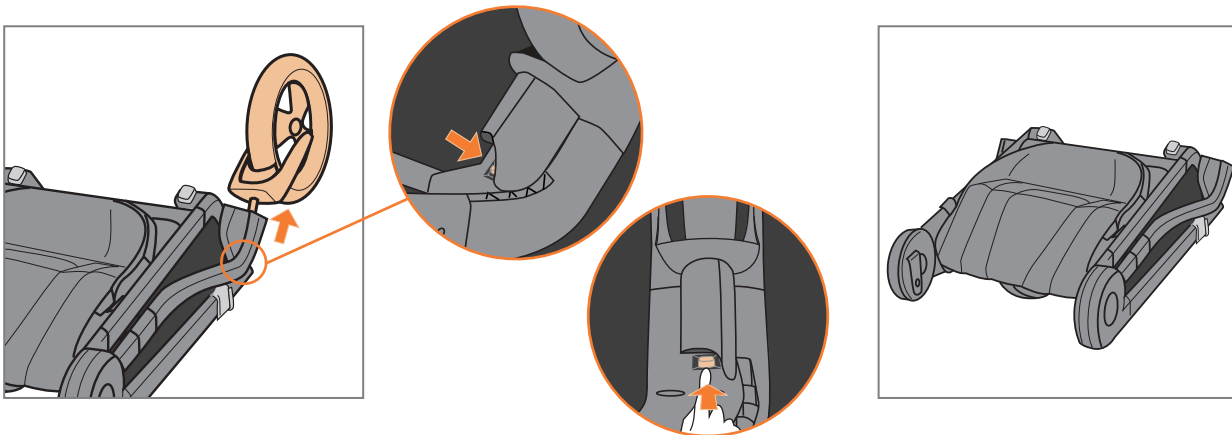

Press the wheel removal button to remove your current wheel.

HOW TO INSTALL THE NEW WHEEL

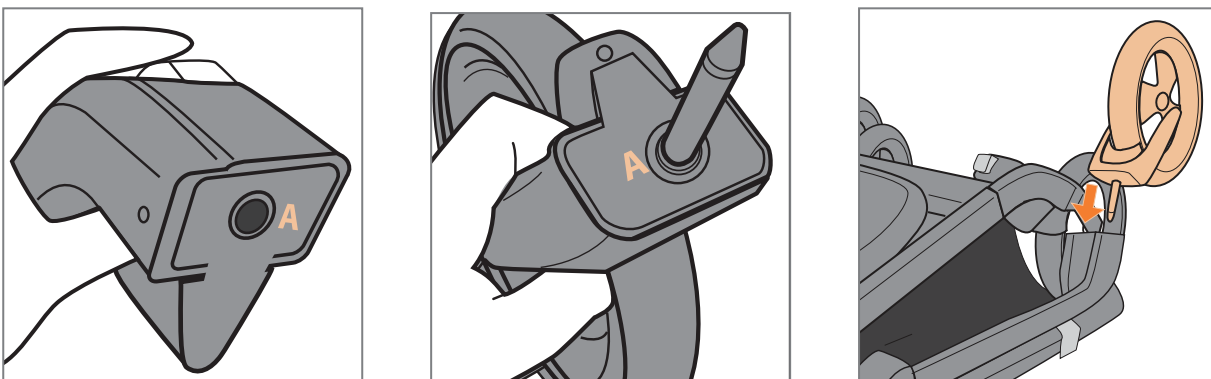

Confirm that the new wheel matches the letter on the current wheel and on the respective stroller mount (A - A and B - B). Insert new wheel into stroller opening until you hear an audible "CLICK". Pull on wheel to confirm wheel is securely installed.